

// 6-UNIT  
**KITCHEN, DINER,  
 RECREATION FACILITY (KDR)**

**SAMPLE UNIT SPECIFICATIONS**

- Food production and food storage capacity to serve up to 150-200 people<sup>1</sup>
- Diner comfortably seats 72 people per sitting<sup>1</sup>
- Walk-in freezer and walk-in cooler
- Fitness area (strength & cardio)
- TV/Rec room
- Male and female washrooms
- Large boot room at main entrance
- Office space
- Engineered for extreme climates
- Ability to complex with other equipment and corridors to create temporary fleet lodges

**SAMPLE UNIT DIMENSIONS**

- 6-UNIT: 56'0" x 72'8"

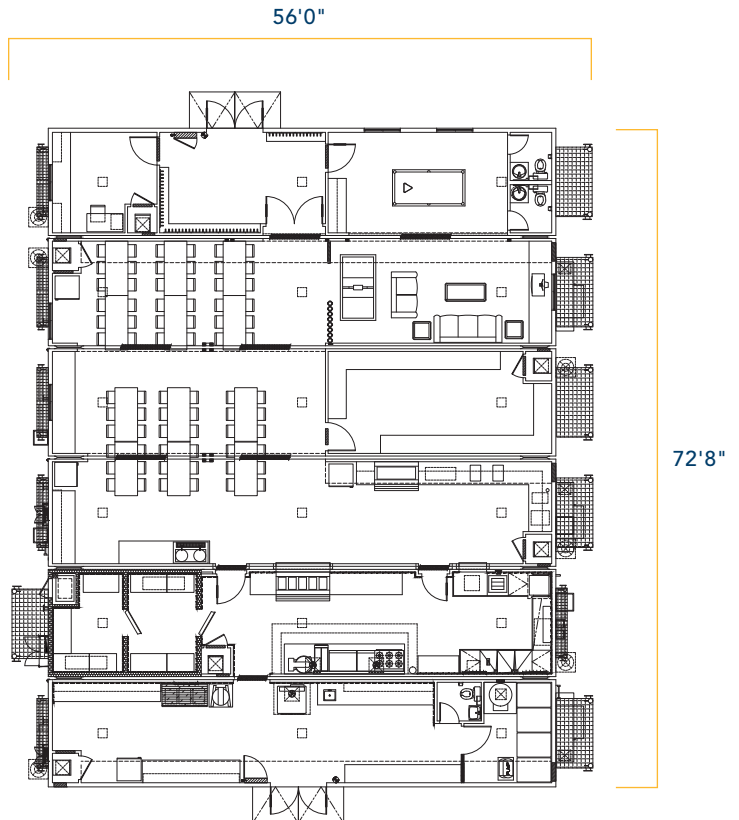

NOTES:

<sup>1</sup> Capacity dependent on unit configuration.

<sup>2</sup> All layouts and renderings are conceptual representations only and subject to variances.