

Wellsite Utility

Dry Storage (192 ft²)

12'-0" x 23'-0" skid



FEATURES

- Ability to use as stand-alone unit
- Ability to customize units to meet clients needs

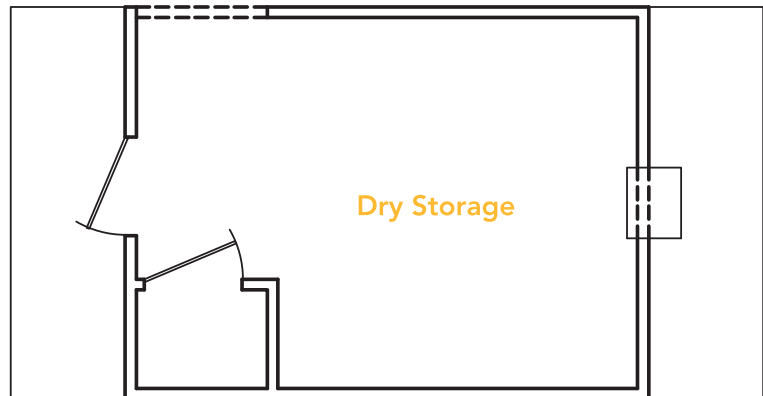

© Civeo. Drawings are for discussion purposes only. Facility layouts and features may vary.
No unauthorized distribution or duplication of this drawing is permitted without expressed written consent.